

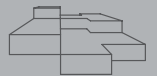

Two-Pump Booster Sets
Fixed and Variable Speed
up to 4 kW

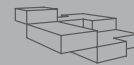
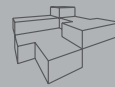

WATER FOR LIFE

RESIDENTIAL BOOSTER SET

Water is a unique and valued natural resource. It should only be entrusted to those who will take care and treat it with respect and passion. Lowara booster sets take every care to deliver the exact volume of water according to your needs, respecting its value, and delivering it where you need it day after day in the right way.



STAINLESS STEEL VERSION variable speed

Frequency Converter

AISI 316 Pumps

AISI 304 Manifolds

AISI 316 Gate valves

AISI 316 Non return valves (check valves)

AISI 316 Pressure transmitter

AISI 316 Pressure Gauge

AISI 316 Fittings

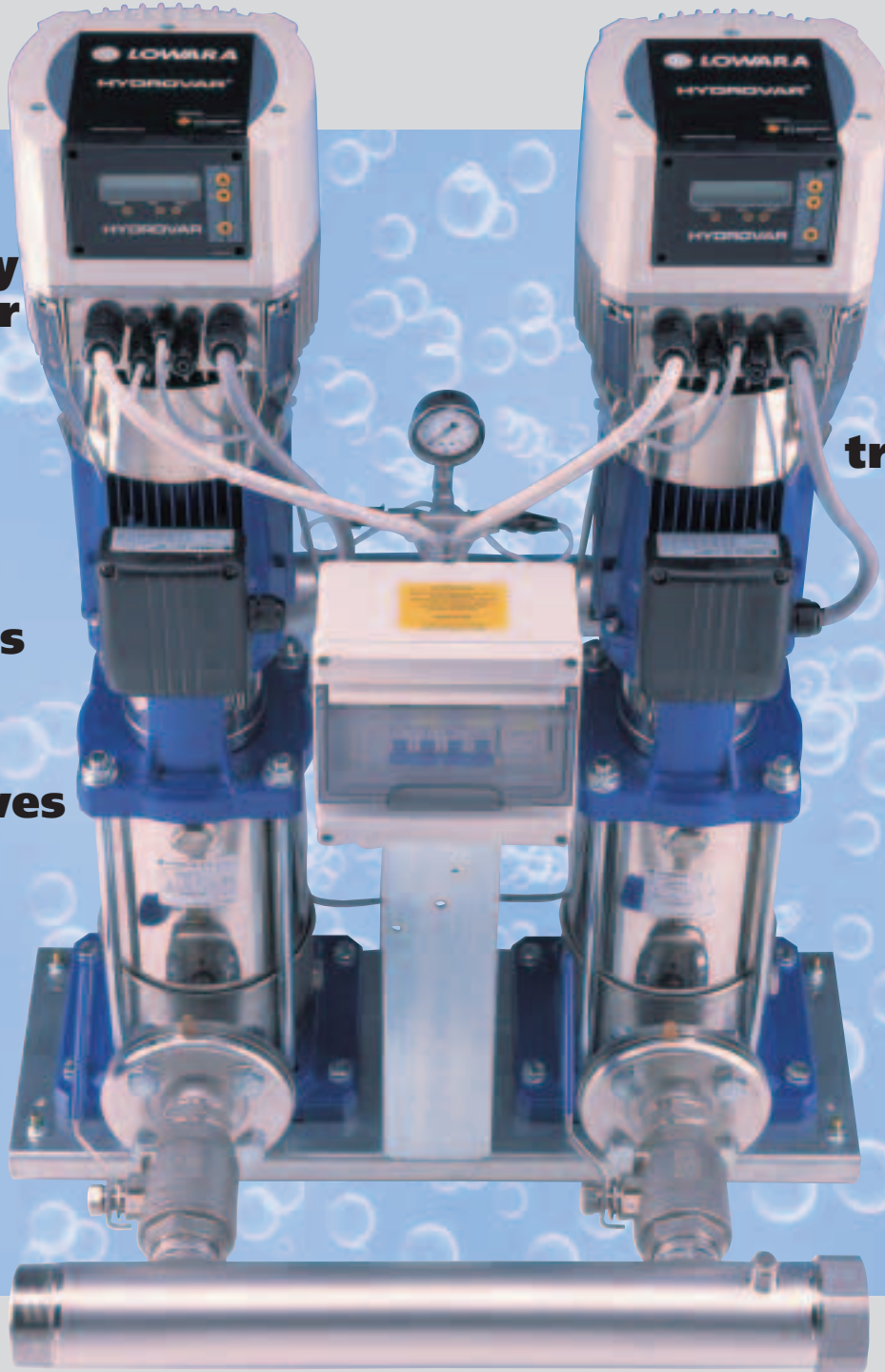

TECHNICAL DATA

MAIN FEATURES

All boosters are equipped with vibration dumping rubber feet, **connection for membrane vessels** on delivery manifold, **non return valve** on delivery side, plugs and caps for unused connections.

Variable speed series GTKS comprises **Teknospeed** Frequency converter, GHV series comprises **HYDROVAR®** frequency converter. Both Teknospeed and Hydrovar Lowara frequency converters are approved on the ECA (Enhanced Capital Allowances) list.

Special versions and options:

- Non return valves on suction side.
- Voltage free contact relays.
- Minimum pressure switch on suction side.
- Special control panels.
- AISI316 manifolds, on demand.



PUMP TYPE	BOOSTER TYPE				
	FIXED SPEED		VARIABLE SPEED		
	GXS20 1 x 230V	GMD20 3 x 400V	GTKS20 1 x 230V	GHV20..M 1 x 230V	GHV20 3 x 400V
BG	•	•	•		
CA	•	•	•		
CEA	•	•	•		
HM	•	•	•		
SV2	•	•	•	•	•
SV4	•	•	•	•	•
SV8	•	•		•	•

WIDE RANGE OF VERSIONS



GHV20

Variable speed

Single phase up to 2 x 2.2 kW

Three phase up to 2 x 4 kW

Max flow 28 m³/h



GMD20

Fixed speed

Three phase up to 2 x 4 kW

Max flow 36 m³/h



GTKS20

Variable speed

Single phase up to 2 x 1.1 kW

Max flow 16 m³/h



GXS20

Fixed speed

Single phase up to 2 x 1.5 kW

Max flow 28 m³/h

General purpose version: galvanized steel manifolds and fittings, brass or nickel plated brass valves.

Drinking water version: stainless steel manifolds, main components in contact with water approved for drinking water or made of stainless steel.

A304, A316 version: all main components in contact with water in stainless steel.

Lowara



ITT Industries
Engineered for life



Lowara is a brand of ITT Water Technology - a subsidiary of ITT Industries

Lowara

